

**Ruedas 1 cojinete canal V. Zincadas**

Roues avec 1 roulement canal V. Zingué

Rodas 1 rolamento canal V. Zincadas

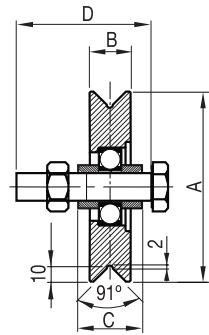

| ∅ A | B  | C  | D       | Kg  | Código        |   |
|-----|----|----|---------|-----|---------------|---|
| 80  | 24 | 32 | M.16x70 | 300 | <b>80-104</b> | 6 |
| 100 | 24 | 32 | M.16x70 | 400 | <b>80-108</b> | 6 |
| 120 | 24 | 32 | M.16x70 | 400 | <b>80-112</b> | 6 |
| 140 | 26 | 36 | M.16x70 | 600 | <b>80-116</b> | 6 |
| 160 | 26 | 36 | M.16x70 | 600 | <b>80-120</b> | 5 |
| 200 | 26 | 36 | M.16x70 | 600 | <b>80-122</b> | 4 |

**Ruedas 1 cojinete canal V. INOX**

Roues avec 1 roulement canal V. INOX

Rodas 1 rolamento canal V. INOX

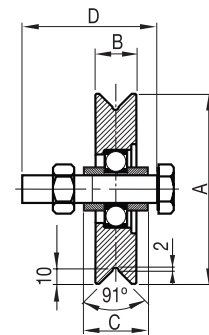
**Inox**

| ∅ A | B  | C  | D       | Kg  | Código        |   |
|-----|----|----|---------|-----|---------------|---|
| 80  | 20 | 33 | M.14x70 | 200 | <b>80-124</b> | 6 |
| 100 | 22 | 33 | M.14x70 | 230 | <b>80-126</b> | 6 |
| 120 | 22 | 33 | M.14x70 | 250 | <b>80-128</b> | 4 |

**Ruedas 2 cojinetes canal V. Zincadas**

Roues avec 2 roulements canal V. Zingué

Rodas 2 rolamentos canal V. Zincadas

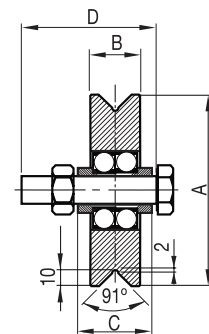

| ∅ A | B  | C  | D       | Kg    | Código           |   |
|-----|----|----|---------|-------|------------------|---|
| 100 | 28 | 44 | M.14x70 | 750   | <b>80-129/10</b> | 5 |
| 120 | 28 | 44 | M.14x70 | 850   | <b>80-129/14</b> | 5 |
| 140 | 32 | 44 | M.16x70 | 900   | <b>80-129/18</b> | 4 |
| 160 | 32 | 44 | M.16x70 | 1.000 | <b>80-129/22</b> | 4 |
| 200 | 32 | 44 | M.16x70 | 1.200 | <b>80-129/26</b> | 4 |